



Product End-of-Life Disassembly Instructions

Product Category: Networking Equipment

Marketing Name / Model

[List multiple models if applicable.]

HP417 Unified Wired-WLAN Appliance(JG971A_9801A0NA,JG972A_9801A0NB)

HP417 Unifd Wrd-WLAN TAA Applnc(JG973A_9801A0NC,JG974A_9801A0ND)

Purpose: The document is intended for use by end-of-life recyclers or treatment facilities. It provides the basic instructions for the disassembly of HP products to remove components and materials requiring selective treatment, as defined by EU directive 2002/96/EC, Waste Electrical and Electronic Equipment (WEEE).

1.0 Items Requiring Selective Treatment

1.1 Items listed below are classified as requiring selective treatment.

1.2 Enter the quantity of items contained within the product which require selective treatment in the right column, as applicable.

Item Description	Notes	Quantity of items included in product
Printed Circuit Boards (PCB) or Printed Circuit Assemblies (PCA)	With a surface greater than 10 sq cm Main Board & Daughter Board.	2
Screw Self-Tapping P2*7mm(十字自攻牙螺絲) in Assy	Screw Self-Tapping P2*7mm For WP333 鍍鎳 (昶輝)	6
Standoff M2*(10.05+5.00)mm (M2 的机械牙十字螺絲) in Assy	Standoff M2*(10.05+5.00)mm For WP338 鍍鎳 (昶輝)	2
Screw Machine P2*6.5mm in Assy	Screw Machine P2*6.5mm For WP338 鍍鎳 (昶輝)	
NUT M2*4*1.6mm in Assy	NUT M2*4*1.6mm For WP338 鍍鎳(昶輝)	

2.0 Tools Required

List the type and size of the tools that would typically be used to disassemble the product to a point where components and materials requiring selective treatment can be removed.

Tool Description	Tool Size (if applicable)
Screw driver	1#

3.0 Product Disassembly Process

3.1 List the basic steps that should typically be followed to remove components and materials requiring selective treatment:

1. Unscrew the screws for mounting angle 1, and then remove the mounting angle 1 from the rack or cabinet.
2. Unscrew&Remove 4 screws "Self-Tapping" from Top&Bottom HP417 housing.
3. Unscrew&Remove 2 screws "Self-Tapping" from HP417 Daughter PCBA and Botteom housing.
4. Unscrew&Remove 2 screws "Machine P2*6.5mm" from HP417 Daughter PCBA and Botteom housing.
5. Unscrew&Remove 2 screws "Standoff M2" from HP417 Main PCBA.
6. Unscrew&Remove 2 screws "NUT M2*4" from HP417 Main PCBA.

3.2 Optional Graphic. If the disassembly process is complex, insert a graphic illustration below to identify the items contained in the product that require selective treatment (with descriptions and arrows identifying locations)

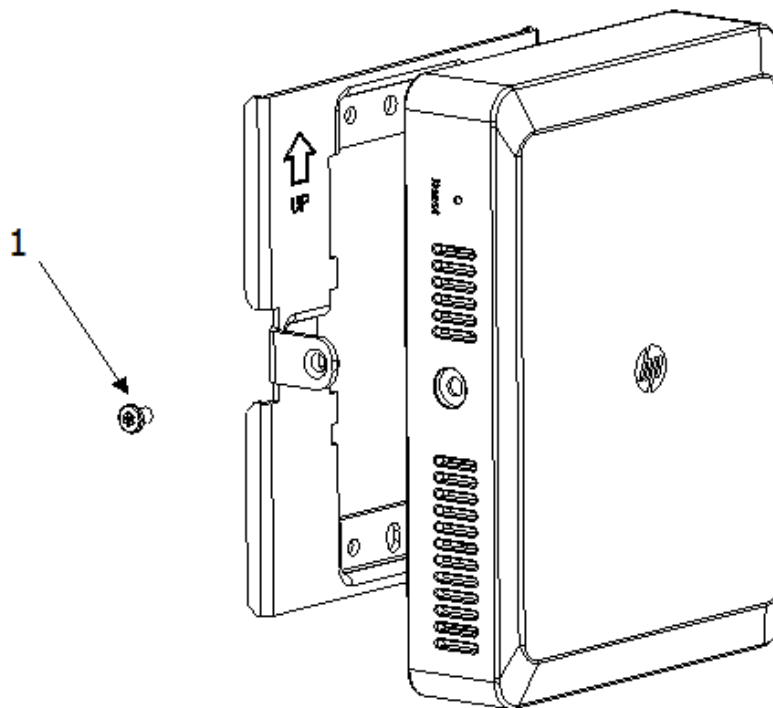

Figure 1. Remove the mounting angle

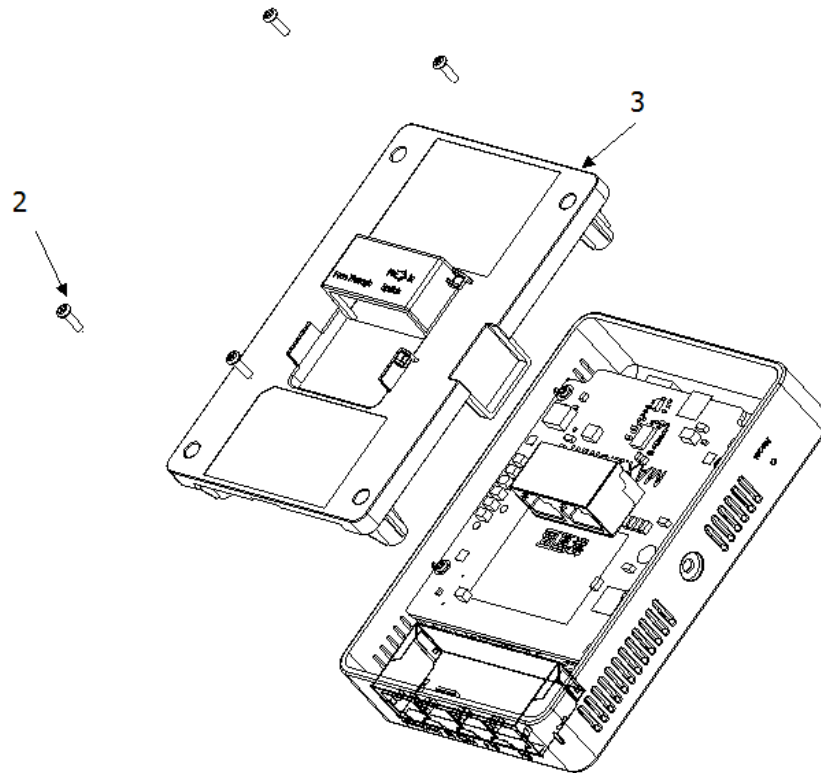

Figure 2. Remove Bottom cover 3

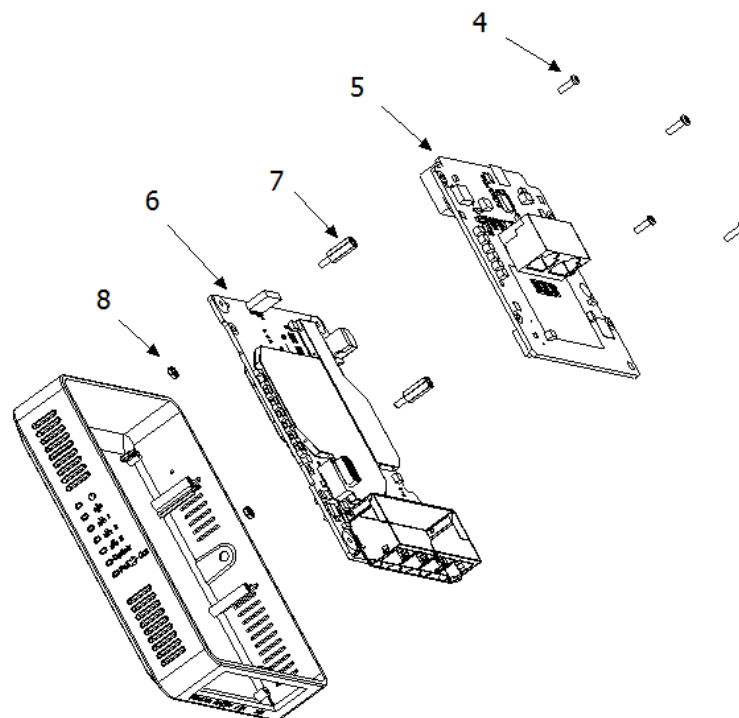

Figure 3. Treatments to STANDOFF and PCB 6

3.4 List the basic steps that should typically be followed to remove components and materials requiring selective treatment:

1. Clear the黑膠& Adhesive tape, if had, in PCBA and housing.

3.5 Optional Graphic. If the disassembly process is complex, insert a graphic illustration below to identify the items contained in the product that require selective treatment (with descriptions and arrows identifying locations)

4.0 Revised record

Date	Version	Author	Modify content
2014.10.27	V1	Bo.Chen/Eddie	Initial version