



Product End-of-Life Disassembly Instructions

Product Category: Calculators

Marketing Name / Model

[List multiple models if applicable.]

H3C S5820V2-52Q-LSWM1HFANSCB

H3C S5820V2-52Q-LSWM1HFANSC

HP X712 Bck(pwr)-Frt(prt) HV Fan Tray-LSWM2FANSCE (JG553A)

HP X711 Frt(prt)-Bck(pwr) HV Fan Tray-LSWM2FANSCEB (JG552A)

Purpose: The document is intended for use by end-of-life recyclers or treatment facilities. It provides the basic instructions for the disassembly of HP products to remove components and materials requiring selective treatment, as defined by EU directive 2002/96/EC, Waste Electrical and Electronic Equipment (WEEE).

1.0 Items Requiring Selective Treatment

1.1 Items listed below are classified as requiring selective treatment.

1.2 Enter the quantity of items contained within the product which require selective treatment in the right column, as applicable.

| Item Description | Notes | Quantity of items included in product |
|------------------------------------------------------------------------------------------------------------------------------------------|---------------------------------------------------------------------------------------|---------------------------------------|
| Printed Circuit Boards (PCB) or Printed Circuit Assemblies (PCA) | With a surface greater than 10 sq cm | 1 |
| Batteries | All types including standard alkaline and lithium coin or button style batteries | 0 |
| Mercury-containing components | For example, mercury in lamps, display backlights, scanner lamps, switches, batteries | 0 |
| Liquid Crystal Displays (LCD) with a surface greater than 100 sq cm | Includes background illuminated displays with gas discharge lamps | 0 |
| Cathode Ray Tubes (CRT) | | 0 |
| Capacitors / condensers (Containing PCB/PCT) | | 0 |
| Electrolytic Capacitors / Condensers measuring greater than 2.5 cm in diameter or height | | 0 |
| External electrical cables and cords | | 0 |
| Gas Discharge Lamps | | 0 |
| Plastics containing Brominated Flame Retardants weighing > 25 grams (not including PCBs or PCAs already listed as a separate item above) | | 2 |
| Components and parts containing toner and ink, including liquids, semi-liquids (gel/paste) and toner | Include the cartridges, print heads, tubes, vent chambers, and service stations. | 0 |
| Components and waste containing asbestos | | 0 |
| Components, parts and materials containing refractory ceramic fibers | | 0 |
| Components, parts and materials containing radioactive substances | | 0 |

2.0 Tools Required

List the type and size of the tools that would typically be used to disassemble the product to a point where components and materials requiring selective treatment can be removed.

| Tool Description | Tool Size (if applicable) |
|------------------|---------------------------|
| Screw driver | 2# |
| | |
| | |
| | |
| | |

3.0 Product Disassembly Process

3.1 List the basic steps that should typically be followed to remove components and materials requiring selective treatment:

1. Unscrew the screws on 2, and then remove 2.
2. Unscrew the screws on 3, and then remove 3.
3. Unscrew the screws on fan 4, and then remove fan 4.
4. Unscrew the screws on pcb 5, and then remove pcb 5.
5. Unscrew the screws on pulled handle 6, and then remove pulled handle 6.
6. Remove shielding finger 7.
7. Remove all of the labels.

3.2 Optional Graphic. If the disassembly process is complex, insert a graphic illustration below to identify the items contained in the product that require selective treatment (with descriptions and arrows identifying locations).

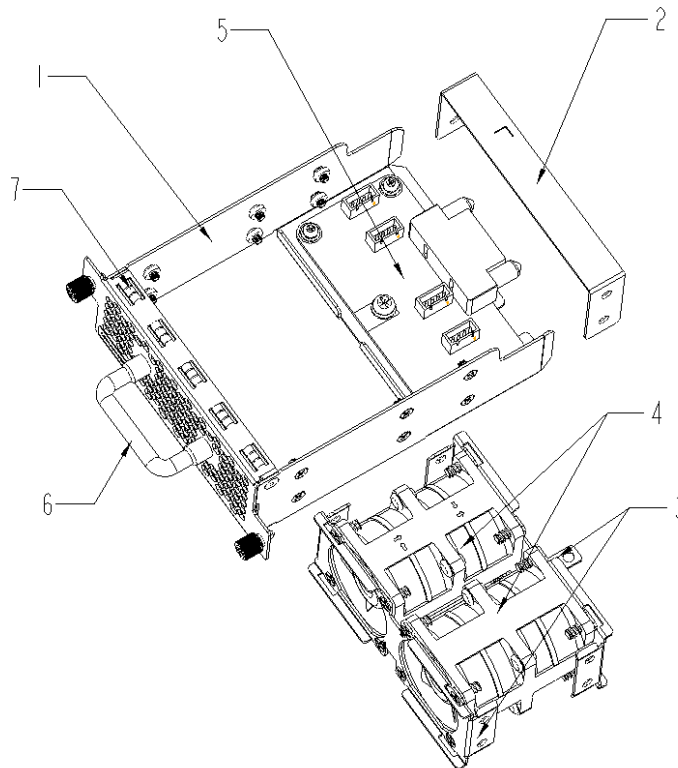

Figure 1 Treatments to fan-assembly

3.3 Material of the facility built

| Facility | Components | Material | Weight(g) | Weight percentage | Selective treatment for materials and components | Details |
|----------|------------|-------------|-----------|-------------------|-----------------------------------------------------------|--------------|
| | 1 | Fe | 160 | 35.37% | | Fe recycling |
| | 2 | Fe | 21 | 4.64% | | Fe recycling |
| | 3 | Fe | 23 | 5.08% | | Fe recycling |
| | 4 | PC | 80*2 | 35.37% | Containing brominated flame retardants | |
| | 5 | Complex PWB | 30 | 6.63% | The surface of PCB is greater than 10 square centimeters; | |
| | 6 | Fe | 24 | 5.31% | | Fe recycling |
| | 7 | Be-Cu | 4.3*8 | 7.60% | | Cu recycling |

4. Revised record

| Date | Version | Author | Modify content |
|------------|---------|------------|-----------------|
| 2012.11.12 | V0 | LiuBaoquan | Initial version |
| | | | |