



Product End-of-Life Disassembly Instructions

Product Category: Networking Equipment

Marketing Name / Model

[List multiple models if applicable.]

ProCurve 8108fl Switch (J8727A)

ProCurve 8116fl Switch (J8728A)

Purpose: The document is intended for use by end-of-life recyclers or treatment facilities. It provides the basic instructions for the disassembly of HP products to remove components and materials requiring selective treatment, as defined by EU directive 2002/96/EC, Waste Electrical and Electronic Equipment (WEEE).

1.0 Items Requiring Selective Treatment

1.1 Items listed below are classified as requiring selective treatment.

1.2 Enter the quantity of items contained within the product which require selective treatment in the right column, as applicable.

Item Description	Notes	Quantity of items included in product
Printed Circuit Boards (PCB) or Printed Circuit Assemblies (PCA)	With a surface greater than 10 sq cm 1 in product,	3
Batteries	All types including standard alkaline and lithium coin or button style batteries	0
Mercury-containing components	For example, mercury in lamps, display backlights, scanner lamps, switches, batteries	0
Liquid Crystal Displays (LCD) with a surface greater than 100 sq cm	Includes background illuminated displays with gas discharge lamps	0
Cathode Ray Tubes (CRT)		0
Capacitors / condensers (Containing PCB/PCT)		0
Electrolytic Capacitors / Condensers measuring greater than 2.5 cm in diameter or height	Bulk capacitors located on rear of back plane board	2
External electrical cables and cords		0
Gas Discharge Lamps		0
Plastics containing Brominated Flame Retardants		0
Components and parts containing toner and ink, including liquids, semi-liquids (gel/paste) and toner	Include the cartridges, print heads, tubes, vent chambers, and service stations.	0
Components and waste containing asbestos		0
Components, parts and materials containing refractory ceramic fibers		0
Components, parts and materials containing radioactive substances		0

2.0 Tools Required

List the type and size of the tools that would typically be used to disassemble the product to a point where components and materials requiring selective treatment can be removed.

Tool Description	Tool Size (if applicable)
Philips screw driver	# 2
Hex Nut driver.	3/8"

3.0 Product Disassembly Process

3.1 List the basic steps that should typically be followed to remove components and materials requiring selective treatment:

1. Uninstall the Console module from the front top center of chassis by removing 4 of the screws as shown in picture 1.
2. Detach the cable connecting to the Console Module. Refer to Picture 2 for more details.
3. Remove the screws securing the bulkhead to the PCA of the console module.
4. Separate the PCA and the bulkhead.
5. Place the chassis assembly upright and remove screws in the back cover (22 per for 8slot and 30per for 16slot) and remove the cover. Refer to Picture 3 for more details.
6. Remove the hex nuts securing the bulk capacitor to power cables. Refer to Picture 4 for more details.
7. Remove the rest of the hex nut securing the power cables to the backplane. Refer to Picture 5 for more details.
8. Detach the Console cable from the backplane. Refer to Picture 6 for more details.
9. Remove the screws (27per for 8slot and 51 per for 16slot) securing the backplane to the chassis. Refer to Picture 7 for more details.
10. Separate the backplane, power cables, console cables and console module.
11. To remove the power shelf from the chassis. Place the chassis on a workbench facing up.
12. Remove the screws (8per) securing the power supply tray to the power shelf. Refer to picture 8 for more details
13. Push the tray up so as to release the tabs that are hooked into the slot located at the bottom of the chassis. Refer to Picture 9 for more details
14. Separate chassis,power shelf, power supply tray.
15. To dismantle the cables within the power shelf, remove ground cable (5070-0171). Refer to picture 10 for more details.
16. Unplug the cables connecting the AC receptacles. Remove the screws (6 per) securing receptacles to the chassis. Refer to Picture 10 for more details.
17. Unplug the Alarm cable (RST33-054-01). Refer to Picture 10 for more details.
18. Unplug the 3 ground wires (RST5092-1669) from the 3 AC Receptacles (RST9135-5690).
19. To separate the ground wires, remove the nut as shown in Figure 8a of Picture 9.
20. Remove the centre bracket together with cables from the power shelf chassis (RST5069-8640).
21. Remove all the screws and washers securing the cables to the mid-plane assembly and the centre bracket. Refer to Picture 11 for more details.
22. Unplug cables (RST5070-1577).
23. Remove the screws and nuts securing the 3 AC receptacles that are secured to the centre bracket.
24. Remove the mid plane assembly from the centre bracket. Refer to Picture 11 for more details.
25. Separate mid-plane assembly, cables, centre bracket, AC receptacles, screws, washers, nuts.
- 26.
- 27.
- 28.
- 29.
- 30.

3.2 Optional Graphic. If the disassembly process is complex, insert a graphic illustration below to identify the items contained in the product that require selective treatment (with descriptions and arrows identifying locations).

Picture 1



Picture 2

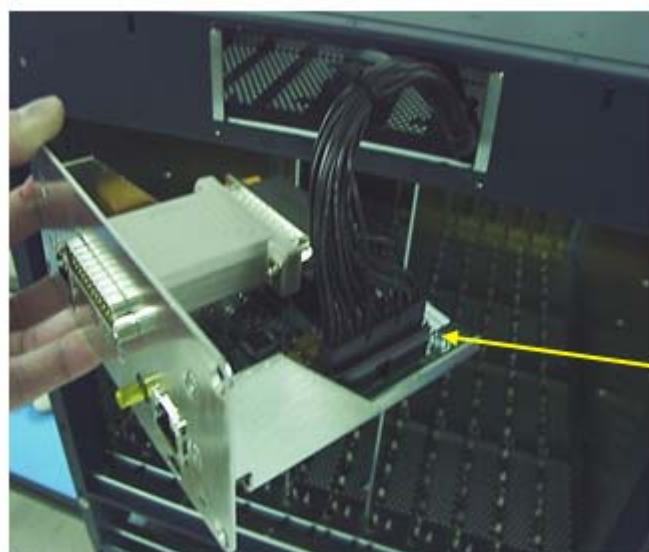

Picture 3



Remove

Picture 4

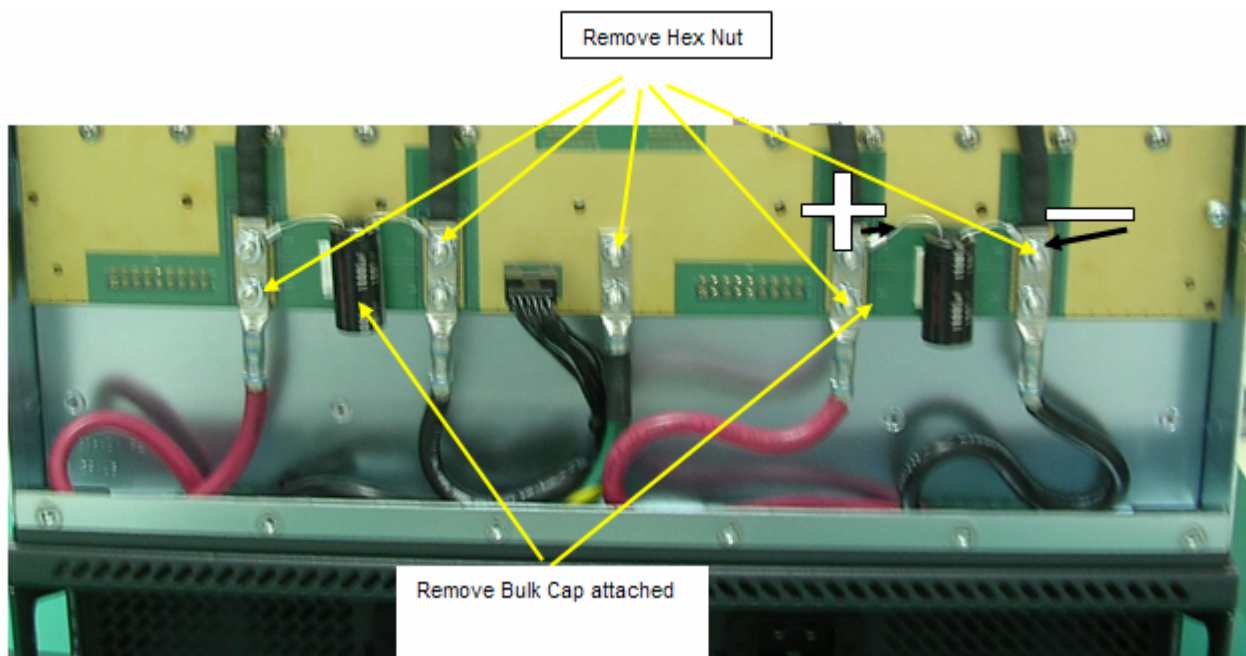

Picture 5

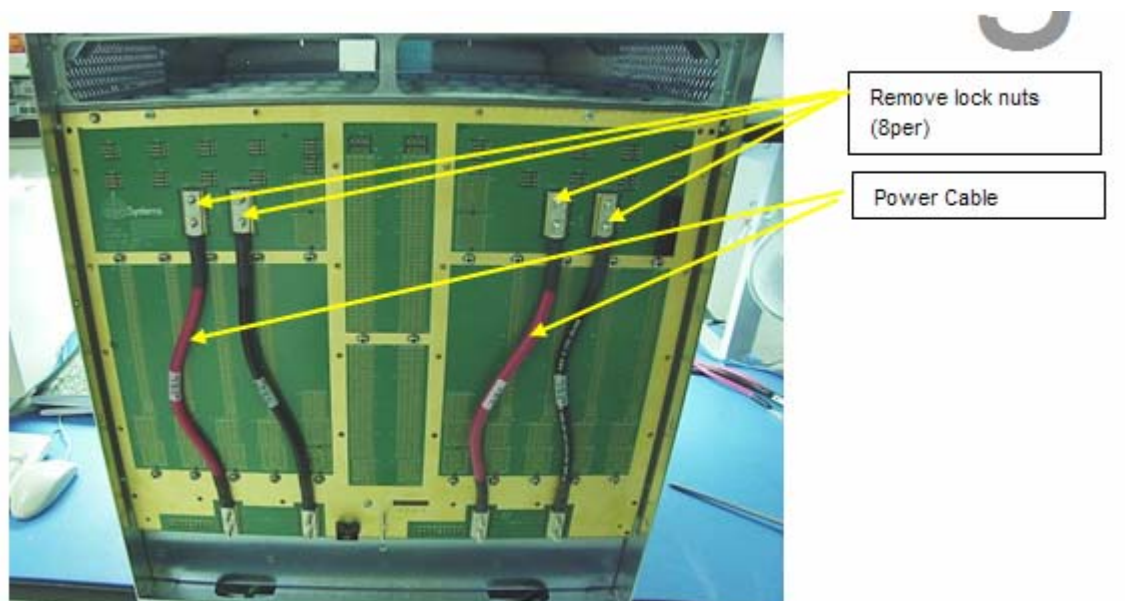

Picture 6



Picture 7

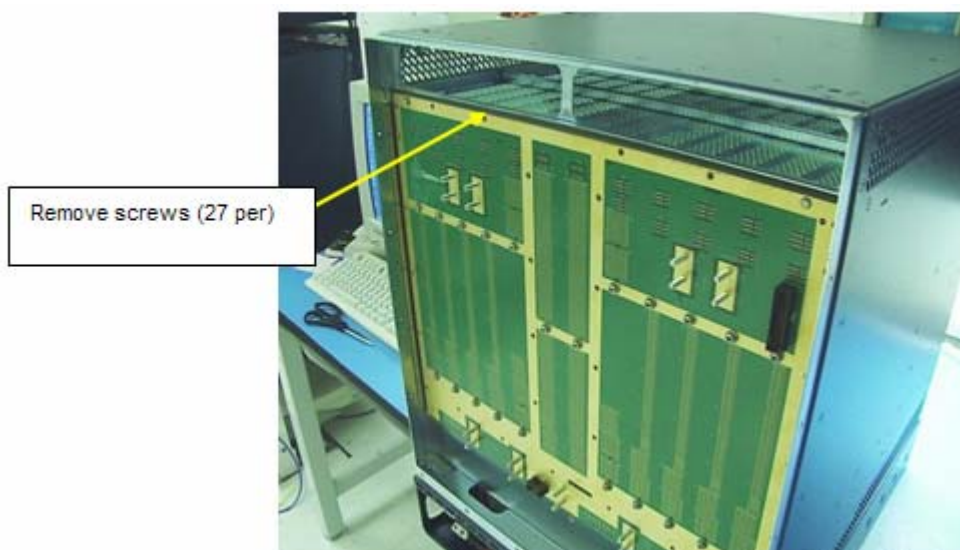

Picture 8

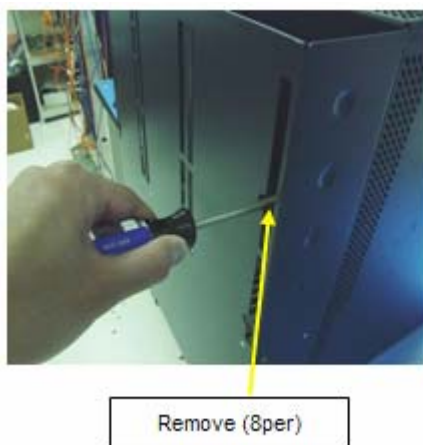

Picture 9

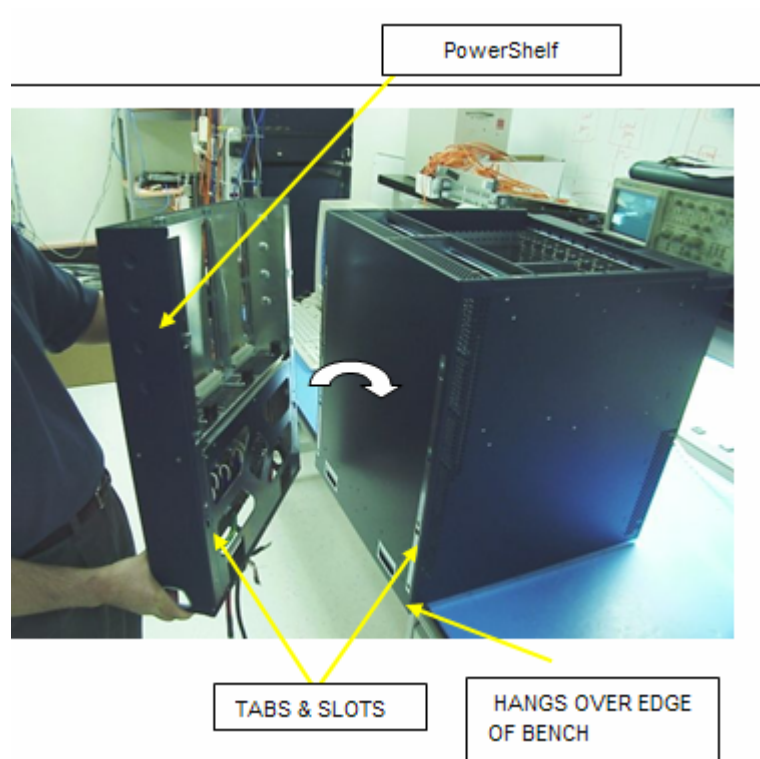

Picture 10

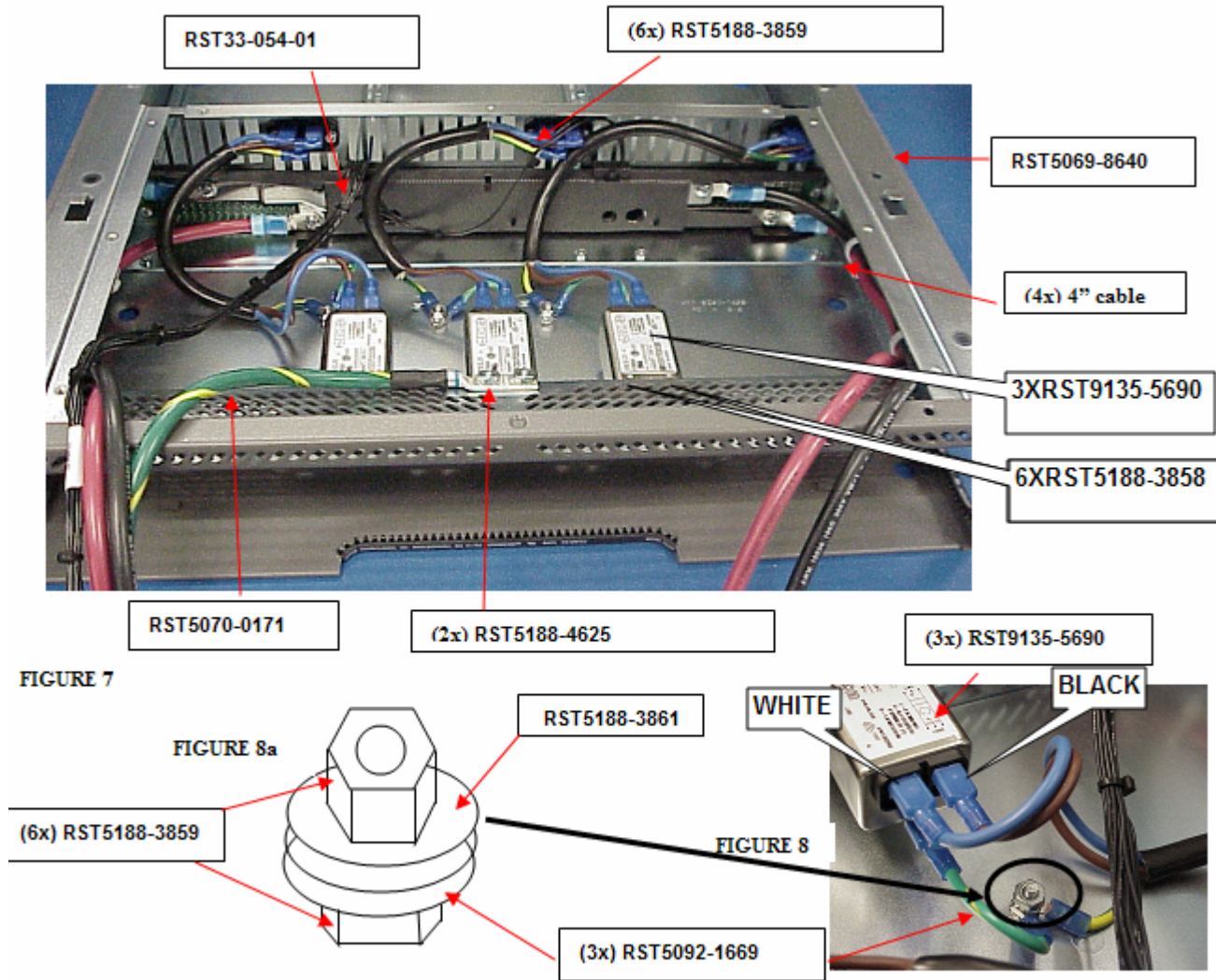

Picture 11

